



DT50-P1113

Dx50

MID RANGE DISTANCE SENSORS

SICK
Sensor Intelligence.



Ordering information

Type	Part no.
DT50-P1113	1044369

Other models and accessories → www.sick.com/Dx50



Detailed technical data

Performance

Measuring range	200 mm ... 10,000 mm, 90 % remission 200 mm ... 6,500 mm, 18 % remission 200 mm ... 4,000 mm, 6 % remission
Resolution	1 mm
Reproducibility	5 mm / 2.5 mm ^{1) 2) 3)}
Accuracy	± 10 mm ⁴⁾
Response time	20 ms ... 30 ms, 20 ms / 30 ms ^{3) 5)}
Output time	≥ 4 ms ⁶⁾
Light source	Laser, red
Laser class	2 (IEC 60825-1:2014, EN 60825-1:2014) ⁷⁾
Typ. light spot size (distance)	15 mm x 15 mm (10 m)
Additional function	Set moving average: fast/slow, switching mode: distance to object (DtO), teach-in, scaling and inversion of switching output, set hysteresis, teach-in, scaling and inversion of analog output, Multifunctional input: laser off / external teach / deactivated, switch-off display, reset to factory default, lock user interface
Average laser service life (at 25 °C)	100,000 h

- ¹⁾ Equivalent to 1 σ .
²⁾ 6 % ... 90 % remission.
³⁾ Dependent on the averaging setting: fast/slow.
⁴⁾ 90 % remission.
⁵⁾ Lateral entry of the object into the measuring range.
⁶⁾ Continuous change of distance in measuring range.
⁷⁾ Wavelength: 658 nm; max. output: 180 mW; pulse duration: 5 ns; duty cycle: 1/200.

Interfaces

Analog output	1 x 4 mA ... 20 mA ($\leq 300 \Omega$)
----------------------	--

- ¹⁾ Output Q short-circuit protected.
²⁾ PNP: HIGH = V_S - (< 2.5 V) / LOW = 0 V.
³⁾ Response time ≤ 15 ms.
⁴⁾ PNP: HIGH = V_S / LOW = ≤ 2.5 V.

Resolution analog output	16 bit
Switching output	1 x PNP (100 mA) ^{1) 2)}
Multifunctional input (MF)	1 x ^{3) 4)}
Hysteresis	10 mm ... 1,000 mm

¹⁾ Output Q short-circuit protected.

²⁾ PNP: HIGH = V_S - (< 2.5 V) / LOW = 0 V.

³⁾ Response time ≤ 15ms.

⁴⁾ PNP: HIGH = V_S / LOW = ≤ 2.5 V.

Mechanics/electronics

Supply voltage V_S	DC 10 V ... 30 V ^{1) 2)}
Ripple	≤ 5 V _{pp} ³⁾
Power consumption	≤ 2.1 W ⁴⁾
Initialization time	≤ 250 ms
Warm-up time	≤ 15 min
Housing material	Housing zinc die cast (ZNAL4CU1) Acrylic glass (PMMA)
Connection type	Male connector, M12, 5-pin
Indication	LC display, 2 x LED
Weight	200 g
Enclosure rating	IP65
Protection class	III

¹⁾ Limit values, reverse-polarity protected, operation in short-circuit protected network: max. 8 A.

²⁾ For DT50-xxx4: $V_S > 15$ V.

³⁾ May not fall short of or exceed V_S tolerances.

⁴⁾ Without load.

Ambient data

Ambient temperature	Operation: -30 °C ... +65 °C Storage: -40 °C ... +75 °C
Max. rel. humidity (not condensing)	≤ 95 %
Typ. Ambient light immunity	40 klx
Vibration resistance	EN 60068-2-6 / EN 60068-2-64
Shock resistance	EN 60068-2-27

Classifications

ECI@ss 5.0	27270801
ECI@ss 5.1.4	27270801
ECI@ss 6.0	27270801
ECI@ss 6.2	27270801
ECI@ss 7.0	27270801
ECI@ss 8.0	27270801
ECI@ss 8.1	27270801
ECI@ss 9.0	27270801
ETIM 5.0	EC001825

ETIM 6.0	EC001825
UNSPSC 16.0901	41111613

Dimensional drawing (Dimensions in mm (inch))

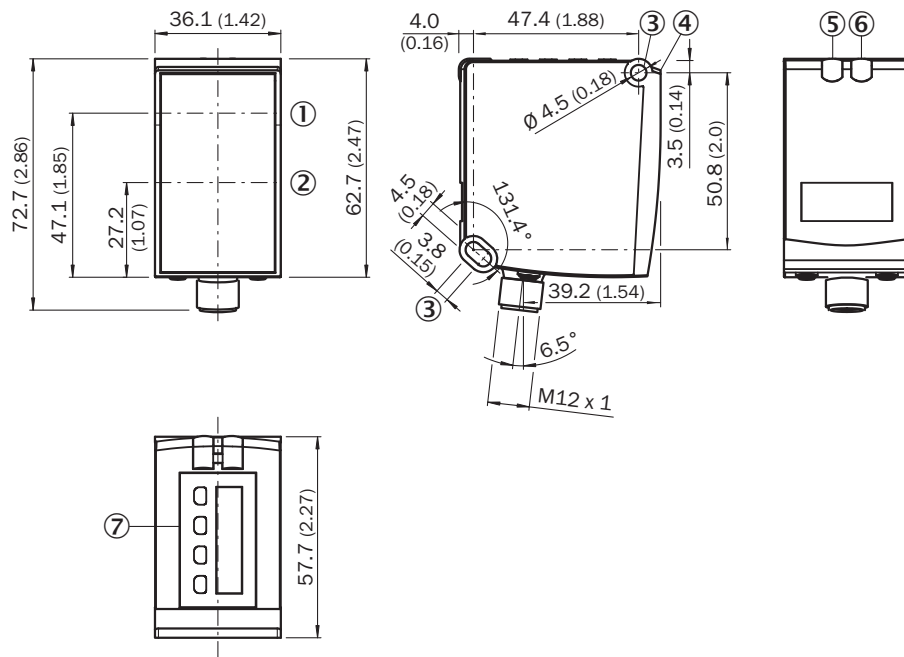

- ① Optical axis sender
- ② Optical axis receiver
- ③ Fixing hole
- ④ Reference surface = 0 mm
- ⑤ Status indicator swichting output Q₁ (orange)
- ⑥ DT50/DT50 Hi/DL50: status indicator power on (green), DS50/DL50 Hi: status indicator switching output Q₂ (orange)
- ⑦ Operating keys and display

Connection type

Male connector M12, 5-pin

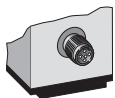

Connection diagram

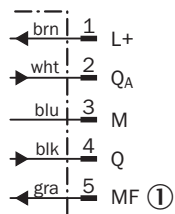

① Multifunctional input (MF)

Recommended accessories

Other models and accessories → www.sick.com/Dx50

	Brief description	Type	Part no.
Plug connectors and cables			
	Head A: female connector, M12, 5-pin, straight Head B: cable Cable: PVC, unshielded, 2 m	DOL-1205-G02M	6008899
	Head A: female connector, M12, 5-pin, straight Head B: cable Cable: Power, I/O, drag chain use, PUR, halogen-free, unshielded, 2 m	DOL-1205-G02MC	6025906
	Head A: female connector, M12, 5-pin, angled Head B: cable Cable: PVC, unshielded, 2 m	DOL-1205-W02M	6008900
	Head A: female connector, M12, 5-pin, angled Head B: cable Cable: Power, I/O, drag chain use, PUR, halogen-free, unshielded, 2 m	DOL-1205-W02MC	6025909
	Head A: female connector, M12, 5-pin, angled, A-coding Head B: cable Cable: HIPERFACE®, drag chain use, PUR, halogen-free, shielded, 5 m Sensor/actuator cable	DOL-1205-W05MAC	6041751

SICK AT A GLANCE

SICK is one of the leading manufacturers of intelligent sensors and sensor solutions for industrial applications. A unique range of products and services creates the perfect basis for controlling processes securely and efficiently, protecting individuals from accidents and preventing damage to the environment.

We have extensive experience in a wide range of industries and understand their processes and requirements. With intelligent sensors, we can deliver exactly what our customers need. In application centers in Europe, Asia and North America, system solutions are tested and optimized in accordance with customer specifications. All this makes us a reliable supplier and development partner.

Comprehensive services complete our offering: SICK LifeTime Services provide support throughout the machine life cycle and ensure safety and productivity.

For us, that is “Sensor Intelligence.”

WORLDWIDE PRESENCE:

Contacts and other locations –www.sick.com